

Direct terminal clamp

## KU 250

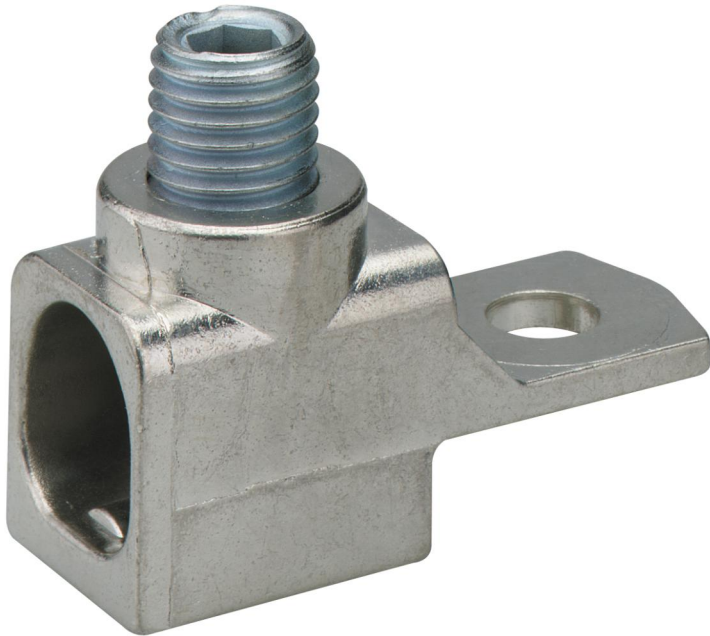

### KU 250

#### Direct terminal clamp

Productnumber: 07625001

Dimensions: 120 x 80 x 30 mm

Direct terminal, universal, for aluminium and copper conductors, from KU 250 also for laminated flat cable

**Direct terminal M10 for conductors, 16-185 mm<sup>2</sup> and laminated flat copper 27 x 16 mm, for load break switch GTE 425**

## Technical Data

### electrical characteristics

shockproof:	No
Connection 1: Connection type:	Screws
Connection 1: Clamping points per pole:	1
Connection 1: Connectable conductor cross-section, single-wire (min):	16 mm <sup>2</sup>
Connection 1: Connectable conductor cross-section, single-wire (max):	185 mm <sup>2</sup>
Connection 1: Connectable conductor cross-section, stranded (min):	16 mm <sup>2</sup>
Connection 1: Connectable conductor cross-section, stranded (max):	185 mm <sup>2</sup>

### Dimensions

Width:	120 mm
Length:	80 mm
Height:	30 mm

### Material characteristics

Industry quality:	no
-------------------	----